

17613 / RF1420

| Position | ItemNo | Description                              |
|----------|--------|--|
| 01       | 10112  | Support Located Nut                      |
| 02       | 15545  | LED Lamp                                 |
| 05       | 12824  | Down Hinge Axis                          |
| 06       | 12822  | Down Hinge                               |
| 08       | 14601  | Leg 115-170 mm (4 Pcs)                   |
| 09       | 15142  | Shelf White 530x650 2/1 GN               |
| 10       | 12552  | Side Support For Guides                  |
| 11       | 12443  | Back Support For Guides                  |
| 12       | 11910  | Door                                     |
|          | 32136  | Door 2020                                |
| 13       | 12825  | Down Hinge Axis Jacket                   |
| 14       | 12587  | Door Gasket                              |
| 15       | 12937  | Spring Hinge                             |
| 16.1     | 32422  | Top Hinge Left 2020                      |
| 16.2     | 32423  | Top Hinge Right 2020                     |
| 19       | 13913  | Sensor Fixed Clip                        |
| 23       | 13229  | Defrost Heating Element M-Shape          |
|          | 15753  | Solenoid Valve                           |
| 24       | 14255  | Evaporator                               |
| 26       | 13284  | Protector                                |
| 31       | 11534  | Evaporator Water Pan                     |
| 32       | 13295  | Water Pan Heater                         |
| 40       | 11817  | Compressor SC21CNX.2 R290                |
| 41       | 13305  | Basket Guard Grill                       |
| 42       | 13382  | Condenser/Evaporator Fan                 |
| 44       | 14114  | Condenser                                |
| 45       | 15724  | Filter Drier 25 G                        |
| 46       | 11424  | Condensate Evaporate Pan                 |
| 51       | 12870  | Hinge For Front Panel                    |
| 52       | 11024  | Front Panel                              |
| 53       | 10682  | Lock                                     |
| 54       | 14066  | Thermostat XR06CX 20A Relay Blue Display |
| 55       | 13754  | Main Switch                              |
| 57       | 12187  | Door Switch                              |
| 60       | 13896  | Probe NTC Dixell/Carel 10 Kohm           |
| 61       | 12517  | Guides L/R (Set) U-Shape                 |
| 62       | 10025  | Filter 445x247                           |
| 71       | 13675  | Motor Contactor                          |
| 72       | 10412  | Cover For Contactor                      |
| 8.1      | 14686  | Wheels (4 Pcs)                           |

2023-01-16

17613 / RF1420

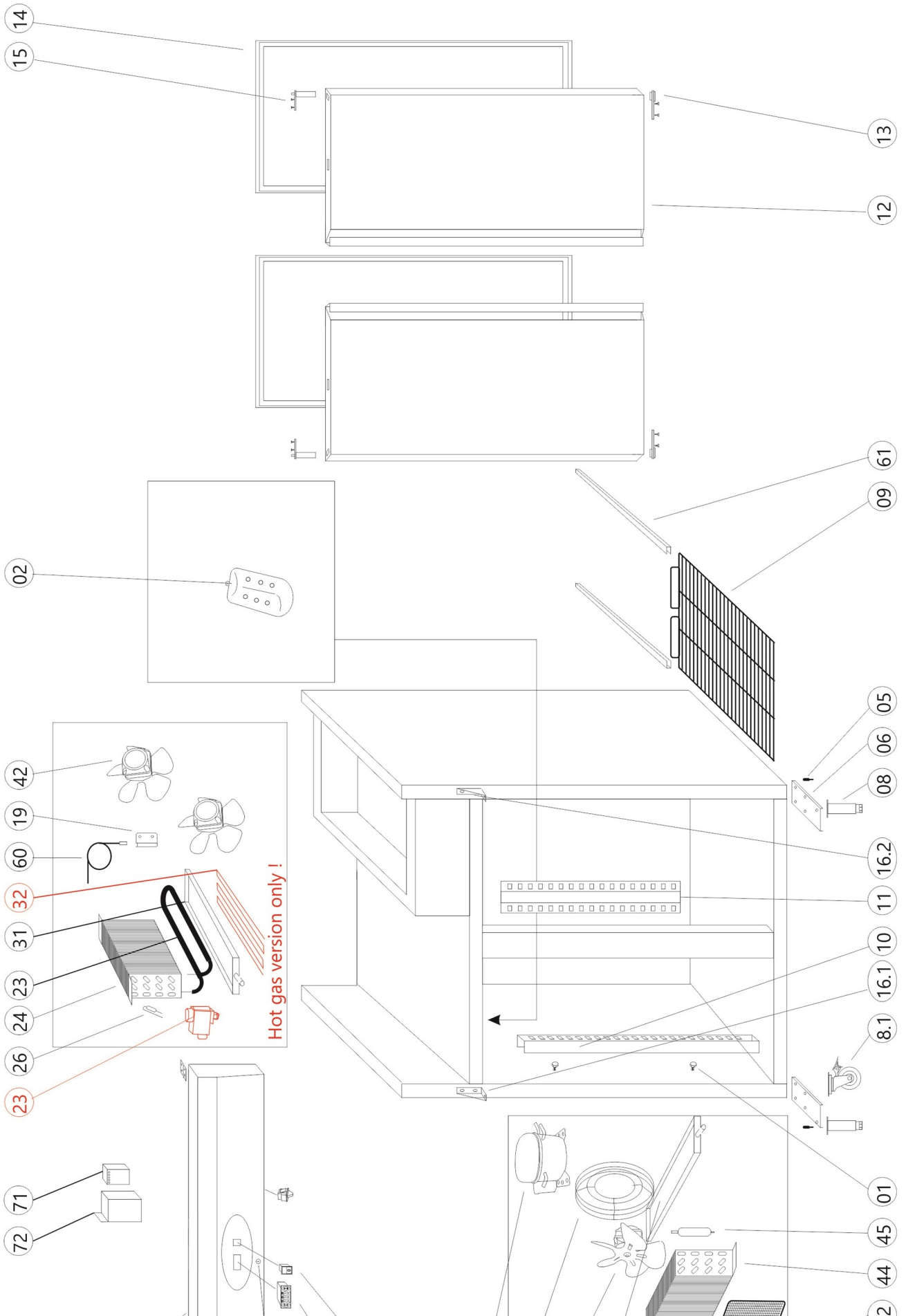

17613 / RF1420

---

